

0771-HS_1-60

Hängeregale

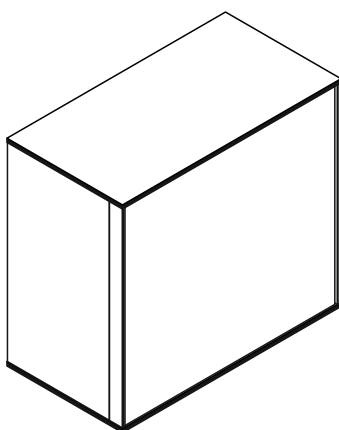

REPC-Nr.:

**Service • Assistenza • Dienstverlening • Serwis
Servis • Szerviz • Сервисная служба**

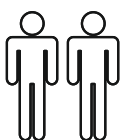
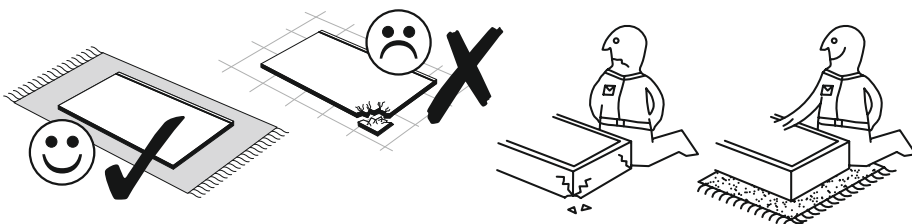
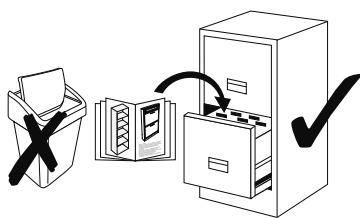
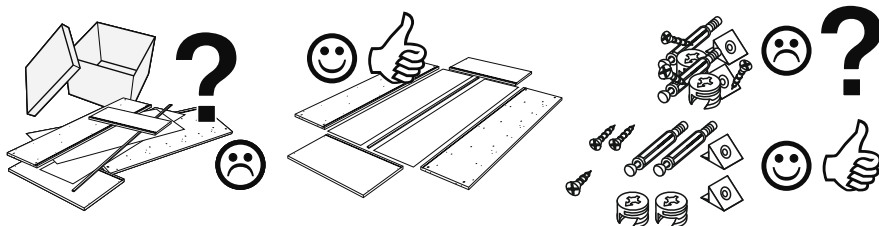
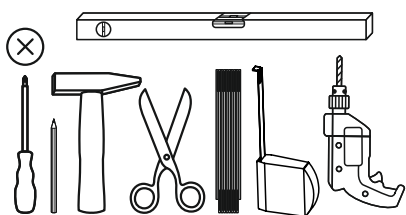

Colli 1/2 : ⑪

Colli 2/2 : ① ② ③ ④ ⑤ ⑥ ⑦ ⑧ ⑨ ⑩ Beutel 1/3, 2/3, 3/3

CHICAGO

Beutel 1/3											
1-10		1-80		1-174		1-190		1-349		2-10	
8x	6,3x50	10x	3,5x13	4x	4,5x50	8x	M4x20	8x	M4	12x	
2-20		2-160		8-70		8-90		8-91			
12x		8x		4x	Ø8	2x		2x			
Beutel 2/3											
3-07		3-11		3-42							
1x		2x		2x	8er						
Beutel 3/3											
3-153		3-157		5-01		5-20		5-260		5-265	
1x	4x	1x	Push	16x		4x		1x	set one by Musterring	1x	set one by Musterring Pflegeanweisung

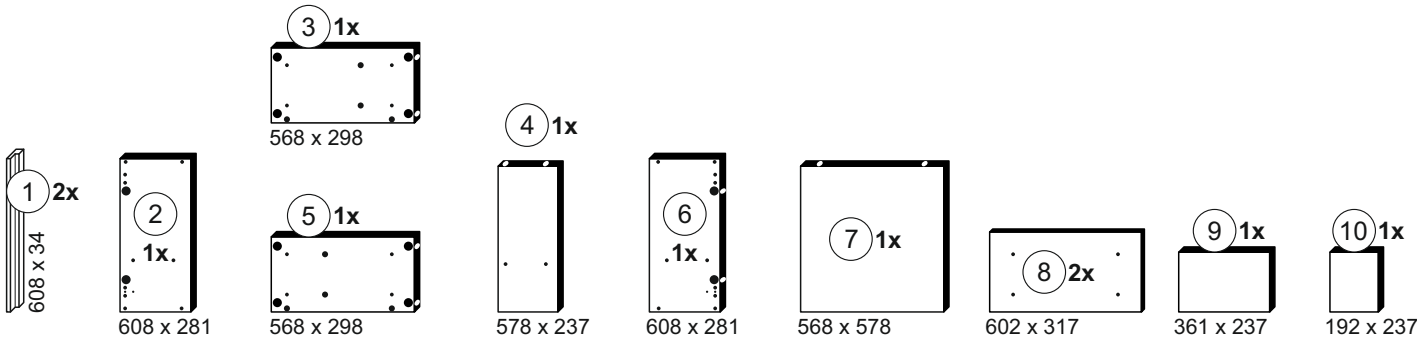
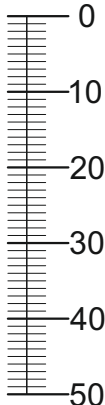

CHICAGO

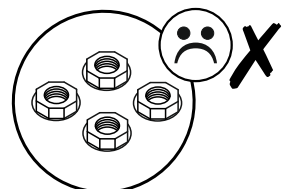
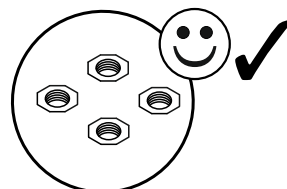
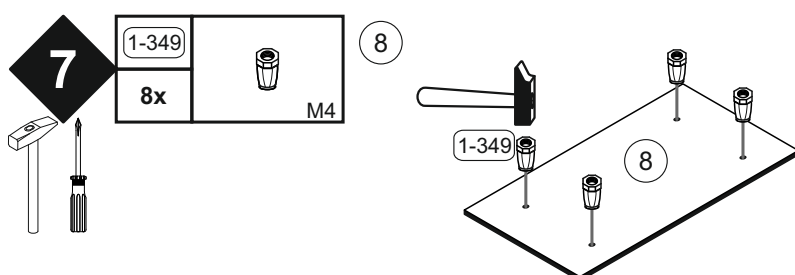
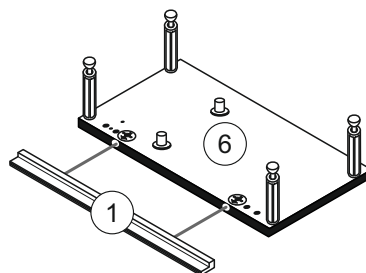
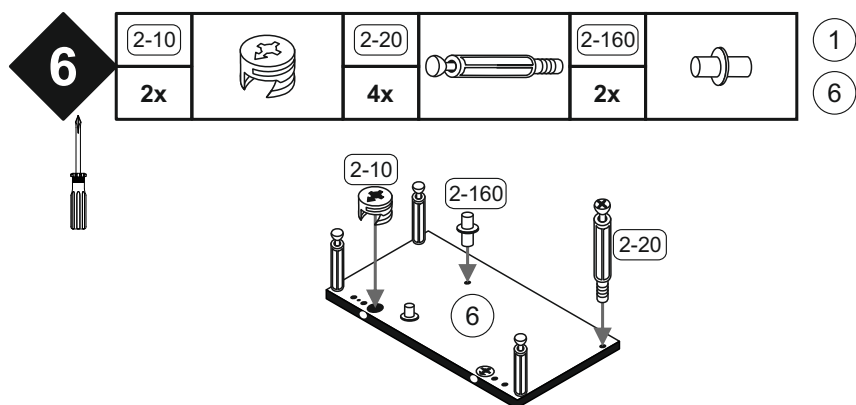
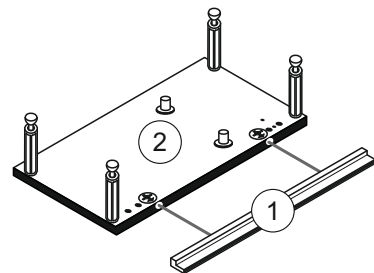
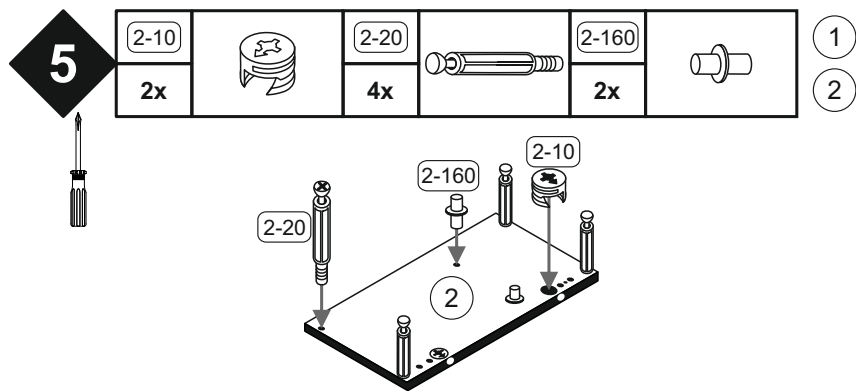
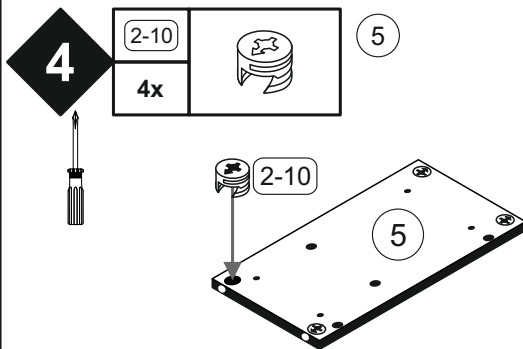
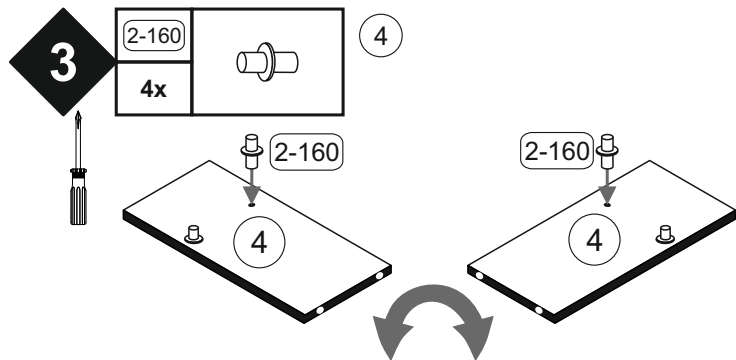
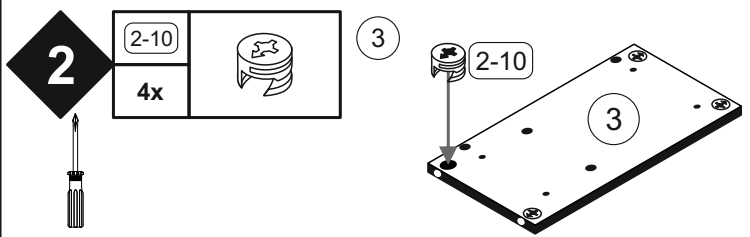
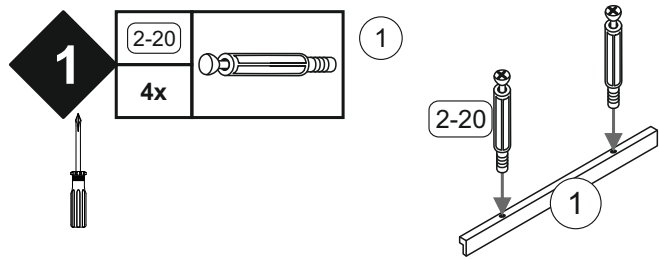



CHICAGO

8

1-10

4x

 6,3x50



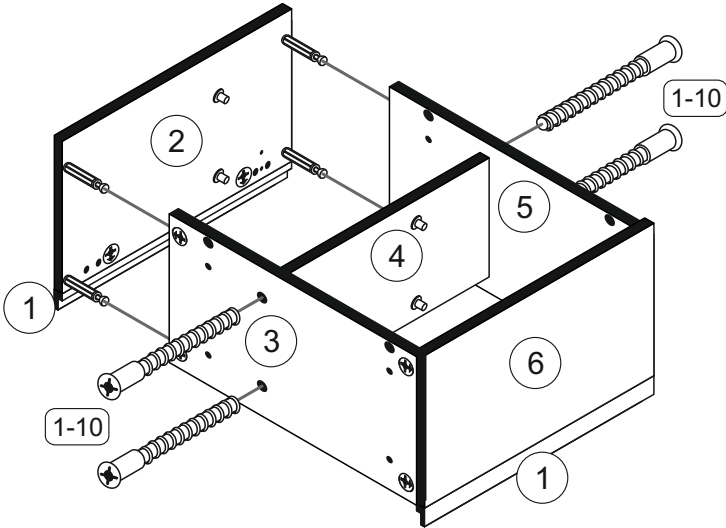
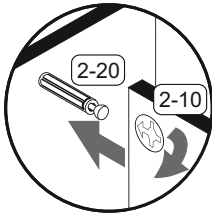



9

1-10

4x

 6,3x50



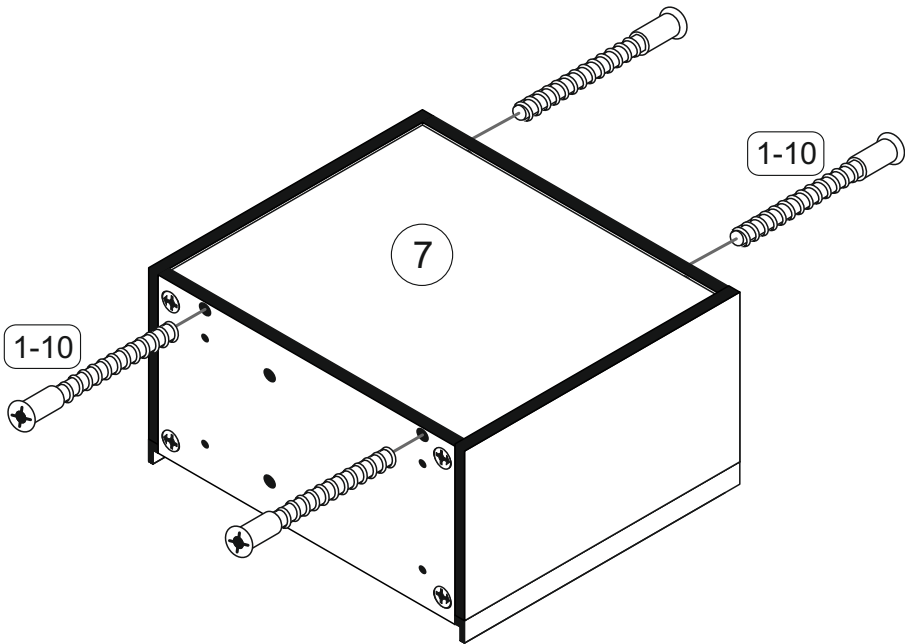



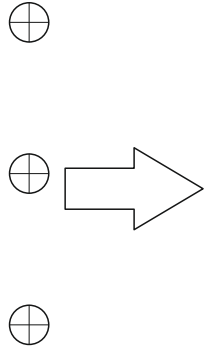
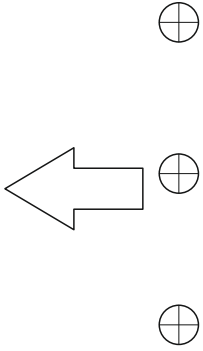

Schablone zum aufhängen

(hierzu die Ecken des Blattes in die Ecke zwischen Seite und Boden anlegen und mit einem Dorn die Löcher vorstechen.)

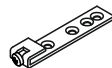

1-80		8-90	
6x	3,5x13	2x	

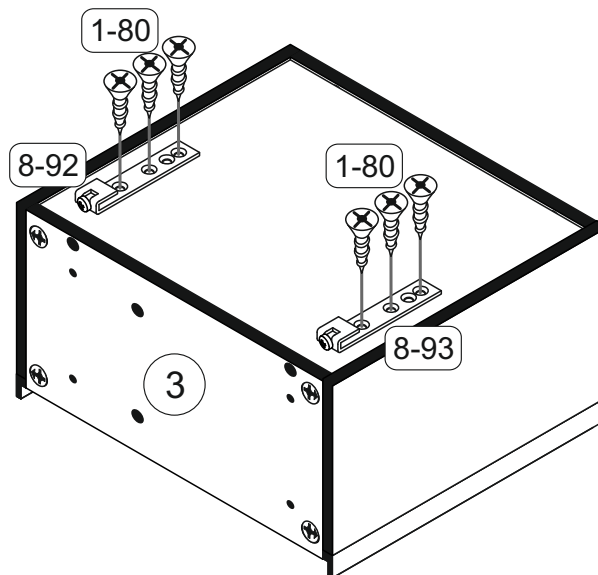

11



1-190		5-20	
8x	M4x20	4x	

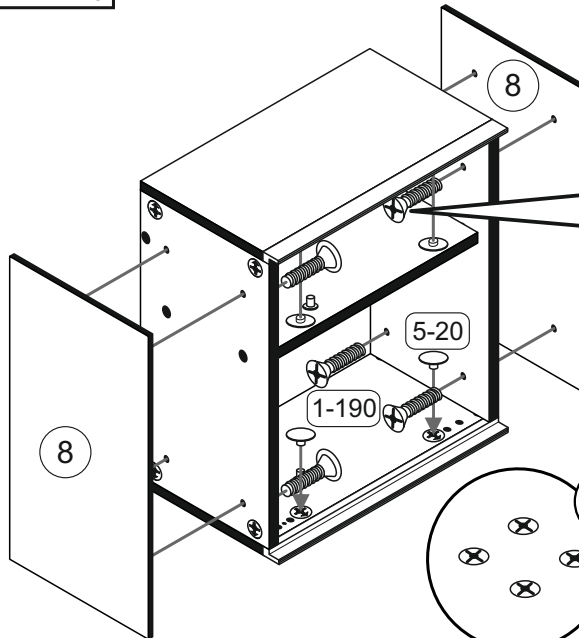

Die Schrauben M4x20 1-190 müssen mit der Hand eingedreht werden.

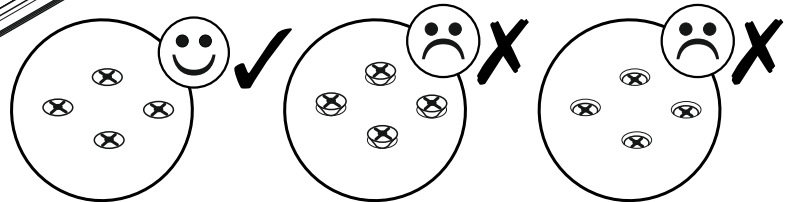
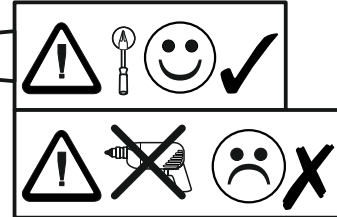

12



1-174		8-91		8-70	
4x	4.5x50	2x		4x	Ø8

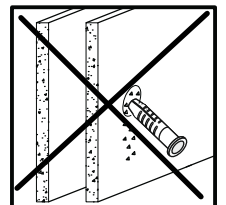
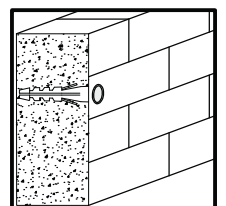
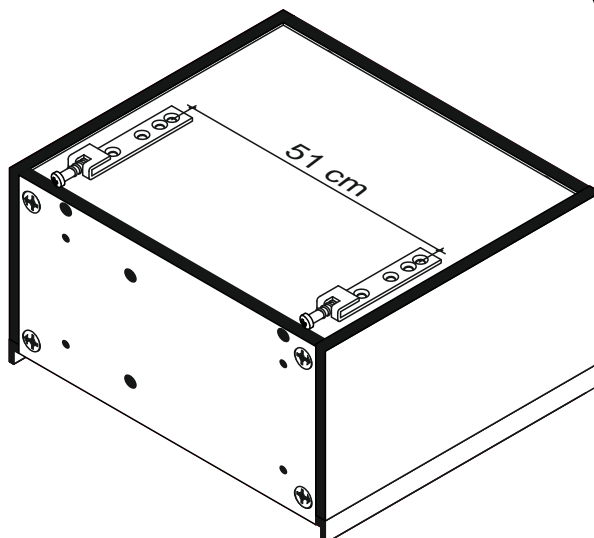
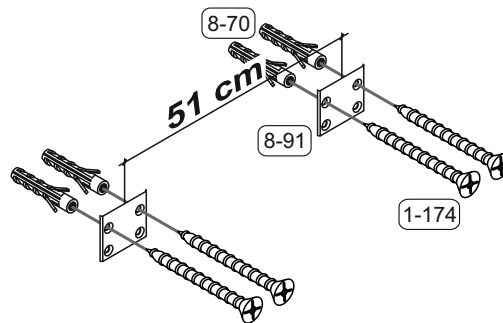
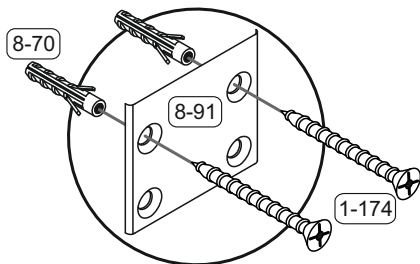

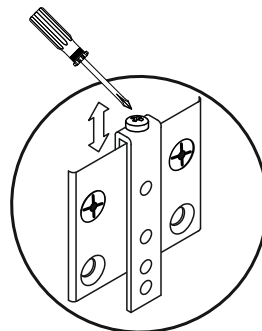
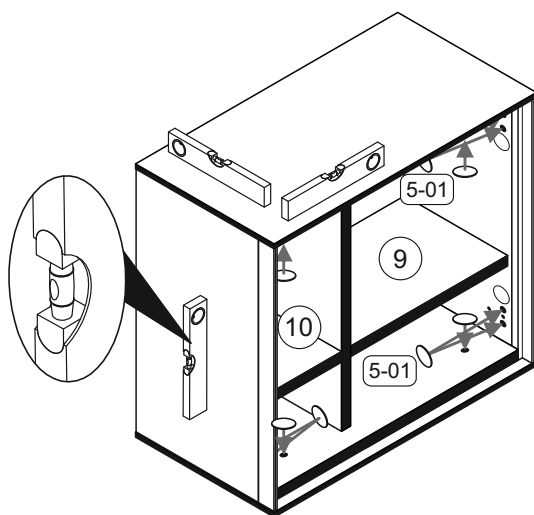
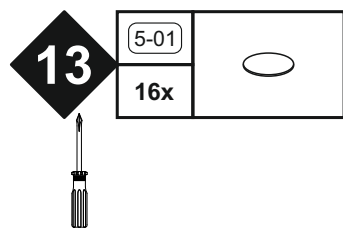

!	Achtung • Attention • Attenzione • Opgelet • Uwaga • Pozor • Figyelem • Atenție • Dikkat • Внимание	!
(D)	Wandbefestigung dient als Kippschutz - unbedingt anbringen! Bei einigen Wandtypen kann ein Spezialdübel erforderlich sein!	
(GB)	The wall fastening serves to prevent tipping - be absolutely sure to mount it! For certain wall types, a special wall plug may be necessary!	
(FR)	La fixation murale sert de protection contre le basculement – à installer impérativement ! Pour certains types de murs il faut des chevilles spéciales !	
(TR)	Duvardaki sabitleme, devrilmeye karşı bir emniyet tedbiridir ve mutlaka monte edilmelidir! Bazı duvar tiplerinde bunun için özel bir dübel gerekli olabilir!	
(IT)	Il fissaggio alla parete serve da protezione anti-ribaltamento – attaccarla assolutamente! Per alcune strutture di parete può essere necessario un tassello speciale!	
(NL)	Bevestiging aan de muur dient als kantelbescherming – zeker en vast bevestigen! Bij enkele muurtypes is een speciale plug misschien vereist!	
(RU)	Обязательно установите крепление на стене во избежание опрокидывания! Для некоторых типов стен может потребоваться специальный дюбель!	
(CZ)	Montáž na stěnu slouží jako ochrana proti převrnutí – bezpodmínečně umístěte! U některých typů stěn může být zapotřebí speciální hmoždinka!	
(HU)	A terméket a falhoz kel rögzíteni, különben az felborulhat! Egyes faltípusoknál speciális tiplit kell használni!	
(RO)	Sistemul de fixare la perete servește ca protecție la răsturnare - de montat obligatoriu! Pentru unele tipuri de pereți este posibil să fie necesar un diblu special!	
(PL)	Mocowanie do ściany jest jednocześnie zabezpieczeniem przed przewróceniem – koniecznie zamontować! Do niektórych rodzajów ścian koniecznie zastosować specjalne kołki mocujące.	
(SK)	Upevnenie na stenu slúži ako ochrana proti prevráteniu – bezpodmienečne použiť! Pre niektoré druhy stien môže byť potrebná špeciálna hmoždinka!	

14

Optional mit Tür

1-80	3,5x13	11
4x		
3-42	8er	
2x		

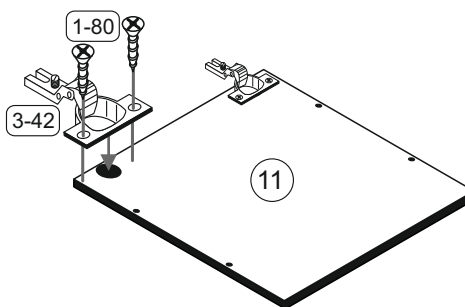

15

3-07	3-11	3-153	4x	3-157	Push	5-260	set one by Musterring
1x	2x	1x		1x		1x	

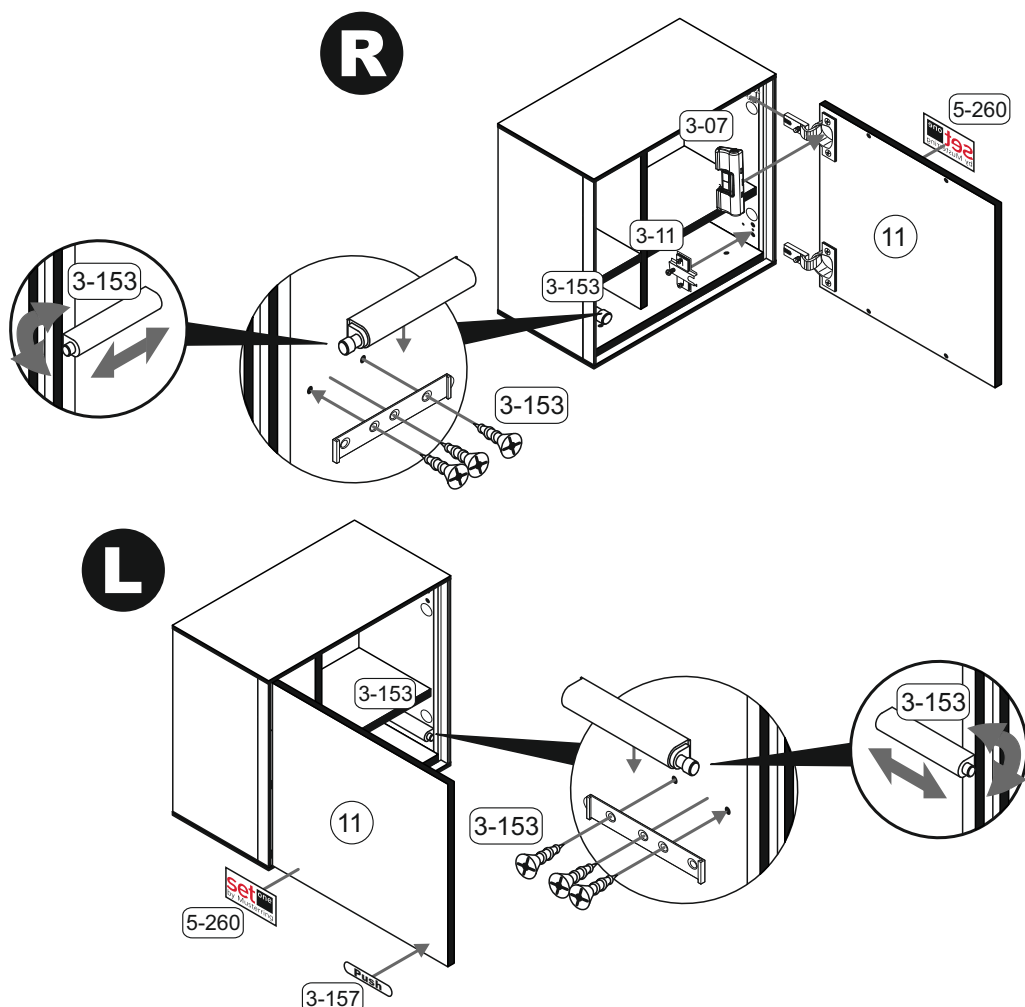

Montage der Türdämpfung

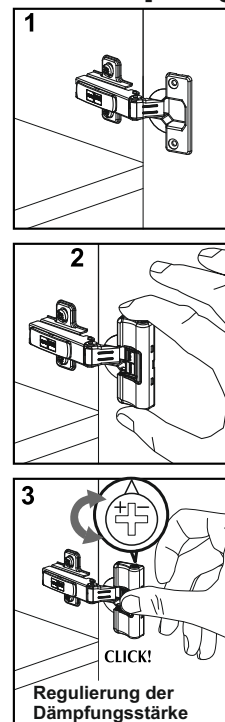

Türen einstellen (Scharniere justieren)

Adjusting the doors (adjusting the hinges)

Régler les portes (ajuster les charnières)

Sistemare le porte (regolare le cerniere)

Deuren instellen (scharnieren afstellen)

Nastawić drzwi (wyregulować zawiasy)

Vyrovnejte dvířka (seřid'te závěsy)

Nastavenie dverí (nastavenie závesov)

Állítsa be az ajtókat (állítsa be a zsanérokat)

Reglare uși (ajustare balamale)

Kapıların ayarlanması (mentşelerin seviye ayarı)

Регулировка дверей (регулировка шарнира)

